



JETFILTER

DIEMME
FILTRATION

DIEMME
FILTRATION

Solutions and Systems

World wide leader in the solid-liquid separation technology for industrial process.

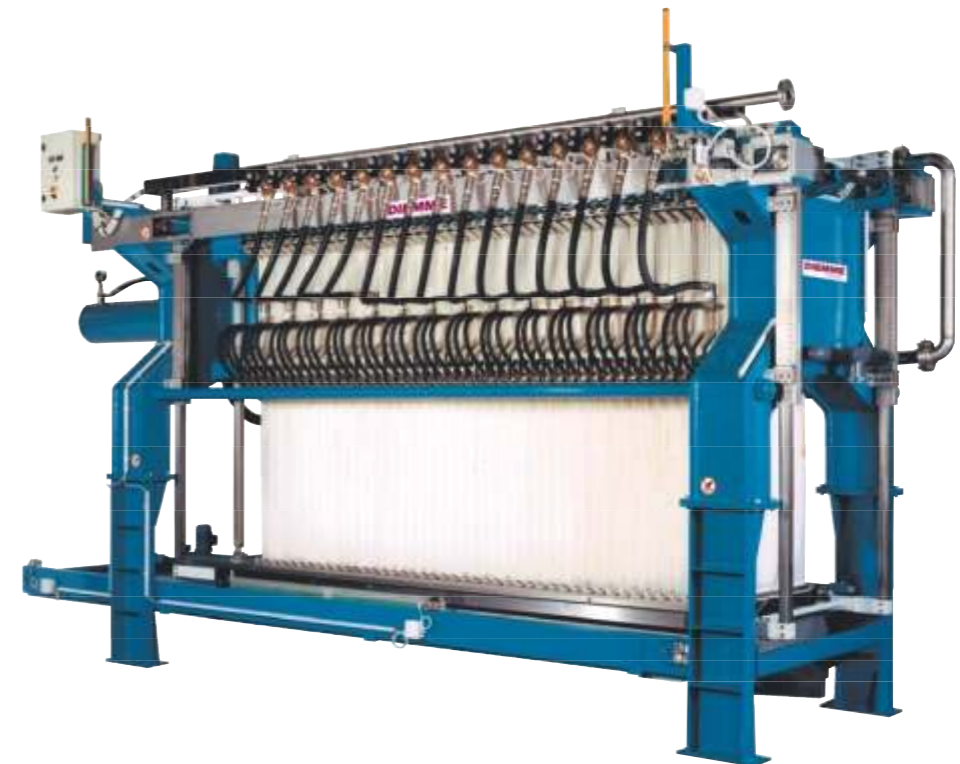

SALES AGENT'S
STAMP

DIEMME S.p.A. reserves the right to bring any alteration at any time which is deemed to be necessary in order to improve its production

DIEMME S.p.A.
Via Bedazzo, 19 - 48022 Lugo (RA) - Italia
Tel. +39 0545 20611 - Fax +39 0545 30358

www.diemme-spa.com - filterdiv@diemme-spa.com

JETFILTER

The future of filtration

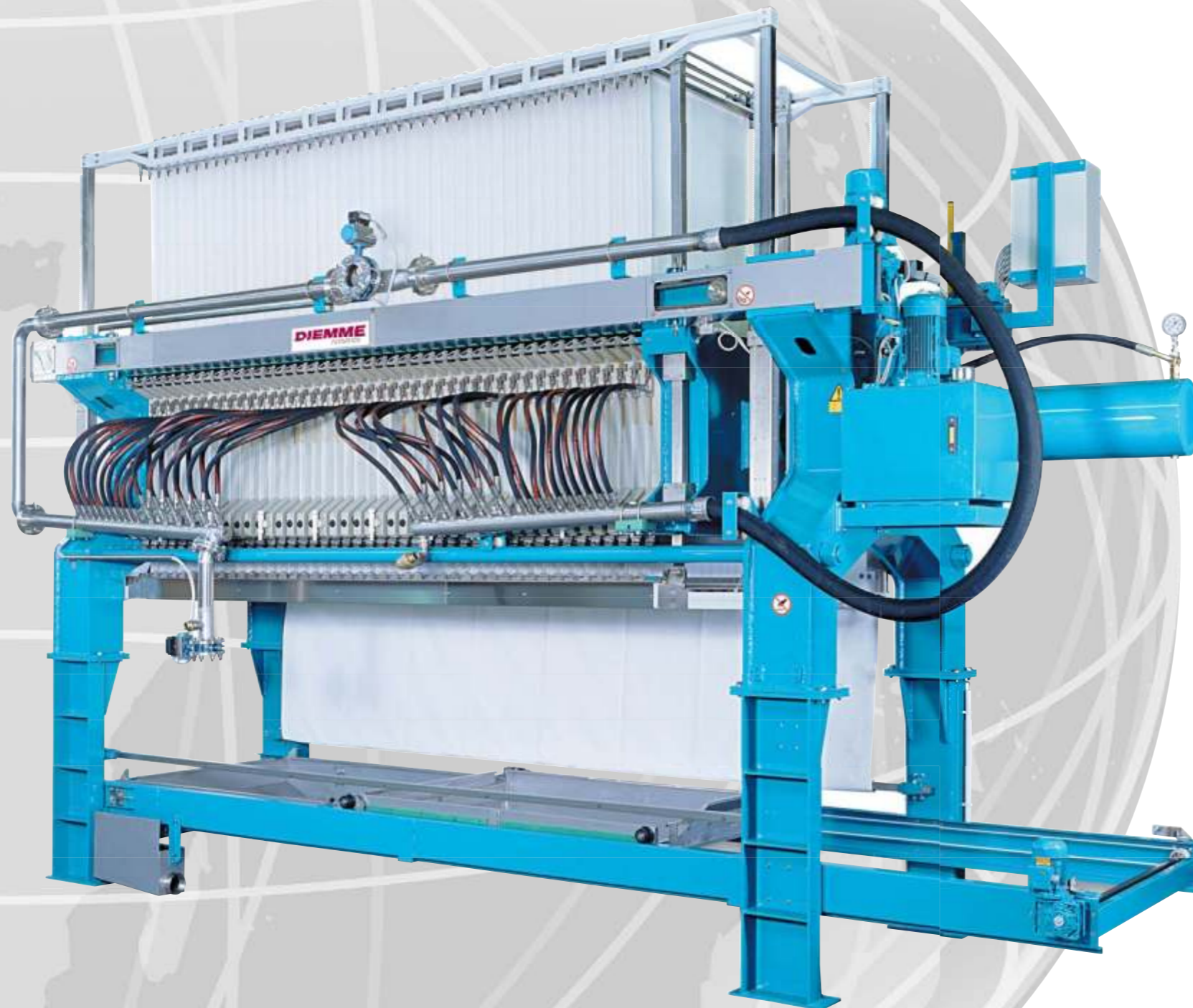

Design

The JETFILTER structure is an overhead beam type and its small size facilitates its installation in small rooms or in existing plants.

Technology

JETFILTER is new concept in filter press design that outperforms all conventional filtration systems. The innovative product injection technology, together with the unique, integrated system of cake discharge and cloth washing, allow the JETFILTER to dewater any kind of suspension very quickly. JETFILTER is fully automatic and can work 24 hours a day continuously without the operator's presence, even when feeding viscous products resulting in very adhesive cakes which are normally difficult to discharge.

Output

Compared to the traditional automatic filter presses, the JET FILTER hourly output is about 4 times higher. The technology implemented in this model, as well as reducing the cycle time, also minimizes the use of chemical filtration aids and consequently, cuts plant operating costs considerably.

Model	Plate size [mm]	Working pressure [bar]	No. of installed plates	Filtration area [m ²]	Frame length [mm]	Frame width [mm]	Frame height [mm]	Empty weight [Kg]
RH 1000.30	1000 x 1000	15	21	30,4	7200	2290	4100	11500
RH 1000.70	1000 x 1000	15	45	66,88	10200	2290	4100	15000
RH 1520.145	1500 x 2000	15	30	145	7500	3000	5150	23000

JETFILTER

A filter press designed to treat the most difficult products rapidly and fully automatically



"Plate-by-plate" feed

A series of injectors puts the product in every single filtration chamber simultaneously. The injection, which is made tangentially, allows fast and homogeneous filling and high filtration speed, even with very abrasive products.



Discharging device

The discharging device is located on the lower side of each plate and is comprised of a series of washing bars. Thanks to the extremely precise design, the washing bars are able to detach the cake without smearing it on the cloths. In this way, even the most adhesive products can be discharged successfully.

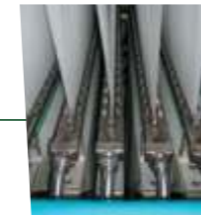

Automatic cloth washing

The automatic cloth washing system is comprised of a series of nozzles attached to the discharging device and allows the cloths to be washed simultaneously, at the end of every cycle. In this way it is possible to guarantee consistent filtration rates, cycle after cycle.



Distribution system

The distribution system controls the flow of wash water to the cloth washing system by means of automatic valves located adjacent to each plate. In this way it is possible to optimize wash water consumption.

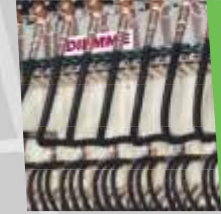

Simultaneous plate shifting

The simultaneous plate shifting system guarantees immediate and simultaneous plate pack opening and minimum idle time during the filtration cycle.



Spare cloths

A complete set of spare cloths is pre-installed on the machine.

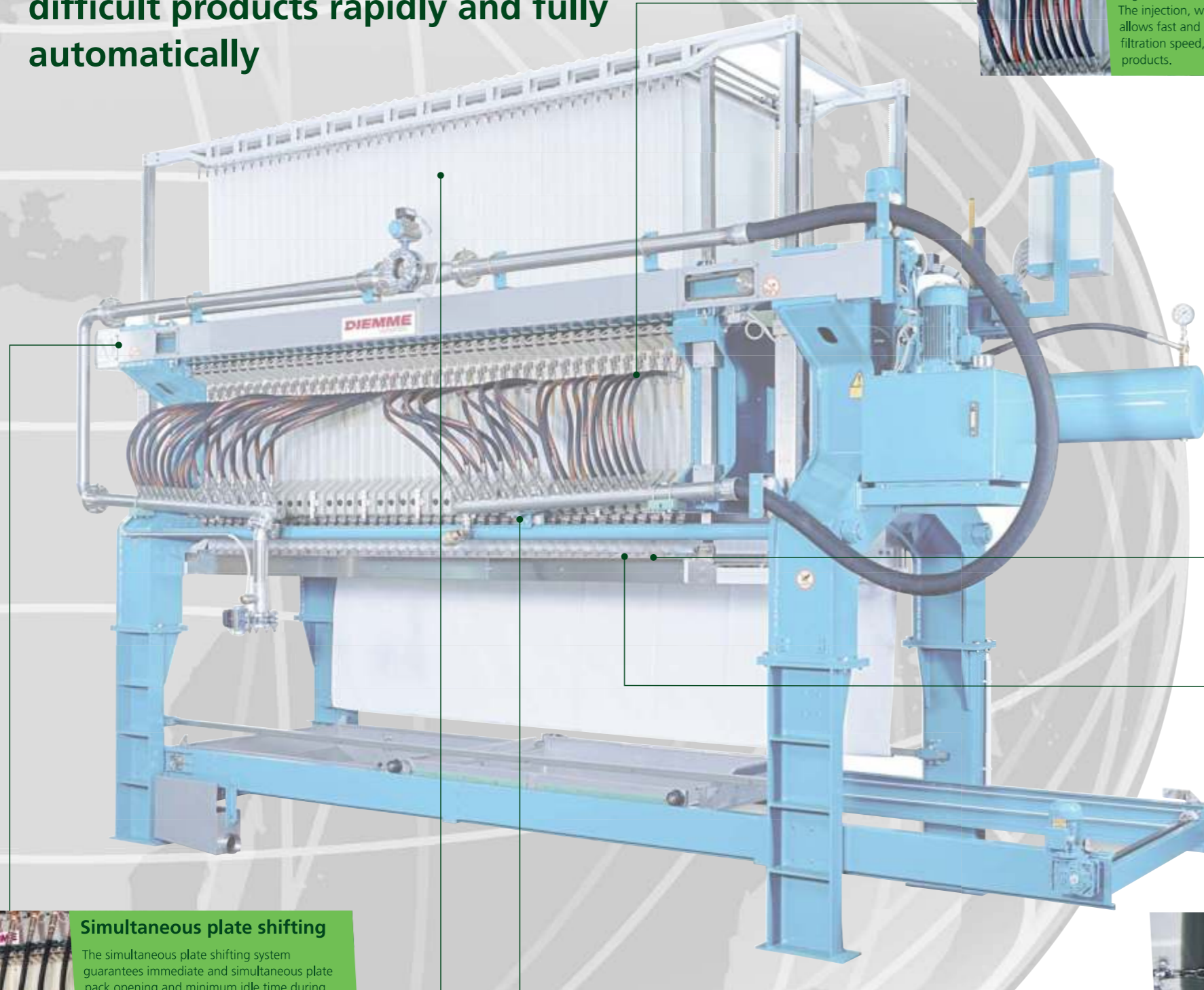

JETFILTER

Patented innovations DIEMME Filtration

Cloth holding frame

JETFILTER is equipped with a new automatic feature which moves all the cloths vertically and simultaneously.

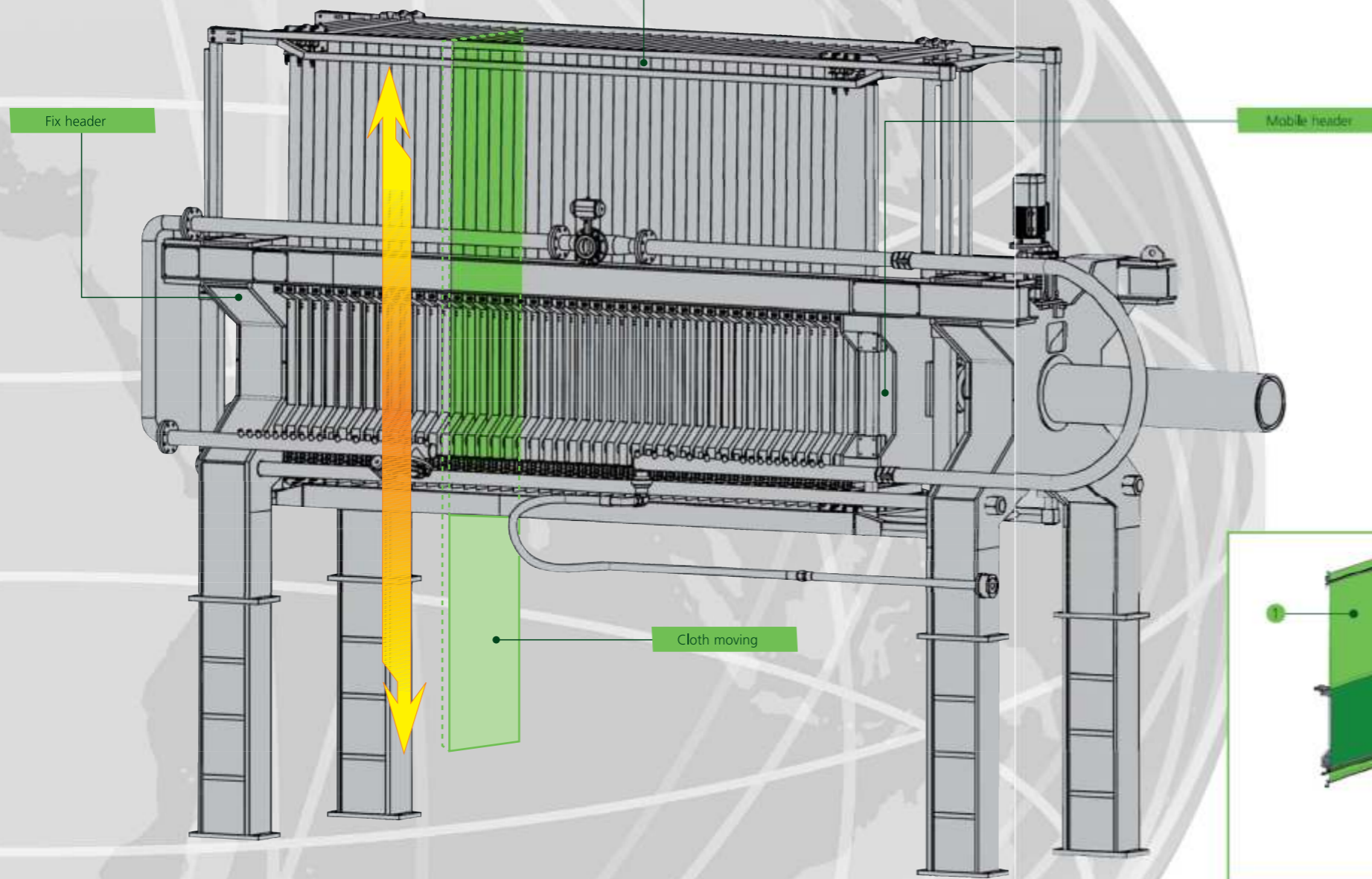

Maximum safety

The structure is designed to minimize stress during all operating conditions and is conservatively sized for maximum safety.

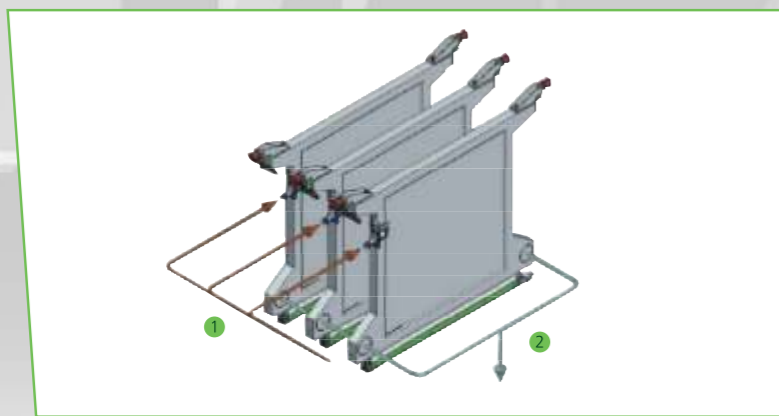
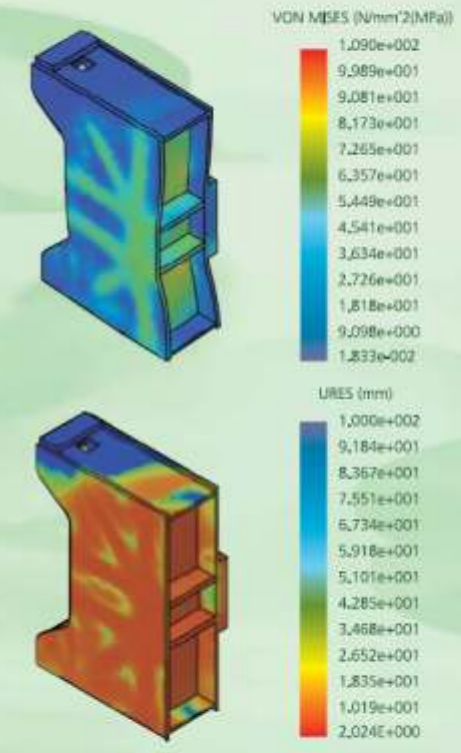

Feeding system

1. The injectors, which are placed in the upper side of the plates, distribute the feed slurry inside every filtration chamber individually and simultaneously.
2. Filtrate is collected in closed filtrate manifolds.

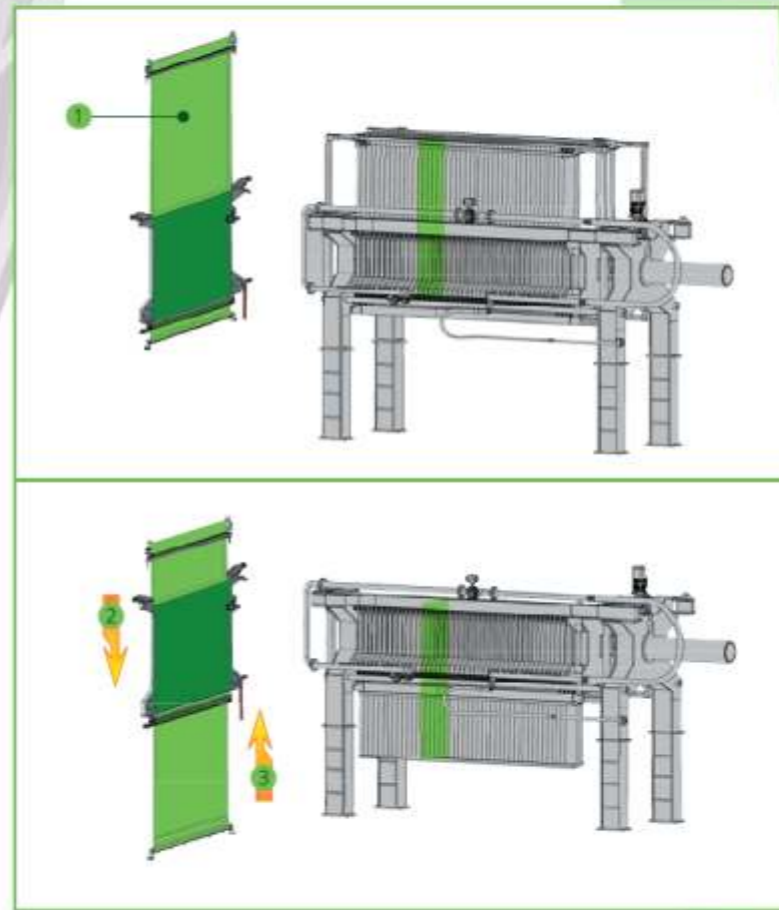

Discharging system

1. FILTRATION. The plate pack is closed and the cloths are in "UP" position.
2. DISCHARGE. The plate pack opens and the frame moves downwards and the cloths pass through the cleaning bars simultaneously. The cakes are discharged and the cloths stop when they reach the "DOWN" position.
3. WASHING. The frame returns the cloths to the "UP" position. During the cloths' re-ascend, the nozzles spray high-pressure water over them.